

CLIFF

SLIM BNC 50 Ohm FRONT MOUNTING METAL FRAME FEEDTHROUGH

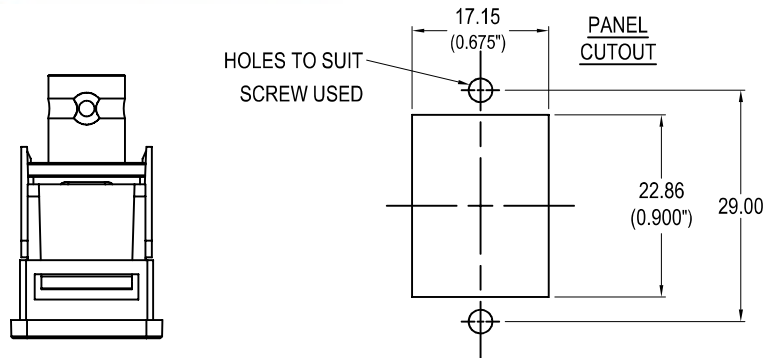

2x HOLE VARIANTS
 $\varnothing 3.2\text{mm}$ CSK 90° x $\varnothing 5.85$
 'X1' PLAIN $\varnothing 3.2$ HOLES

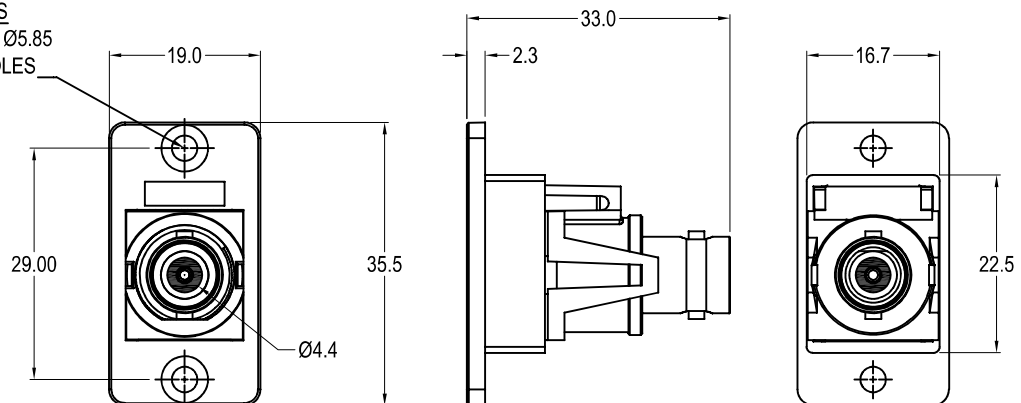

VARIANTS

Part No.

CP30637M

SLIM BNC 50 Ω Nickel frame, CSK holes

CP30637MB

SLIM BNC 50 Ω Black metal frame, CSK holes

CP30637MX1

SLIM BNC 50 Ω Nickel frame, $\varnothing 3.2$ PLAIN holes

CP30637MBX1

SLIM BNC 50 Ω Black metal frame, $\varnothing 3.2$ PLAIN holes

Feedthrough Features

- Fits standard rectangular cutout.
- Various hole mounting options.
- No soldering or punch termination. Use standard cable for each connector style.
- Low rear profile.

Material:

1. SLIM Frame: Diecast, Nickel or black plated
2. BNC Frame: ABS UL94 V2
3. BNC Body: Brass - Nickel Plated
4. BNC Centre: Brass - Copper Plated
5. BNC Insulator: PP UL94 V2

General:

Please note: Functionality is affected by cable quality, length and cable wiring configuration.